

# WALTHAM ROOM

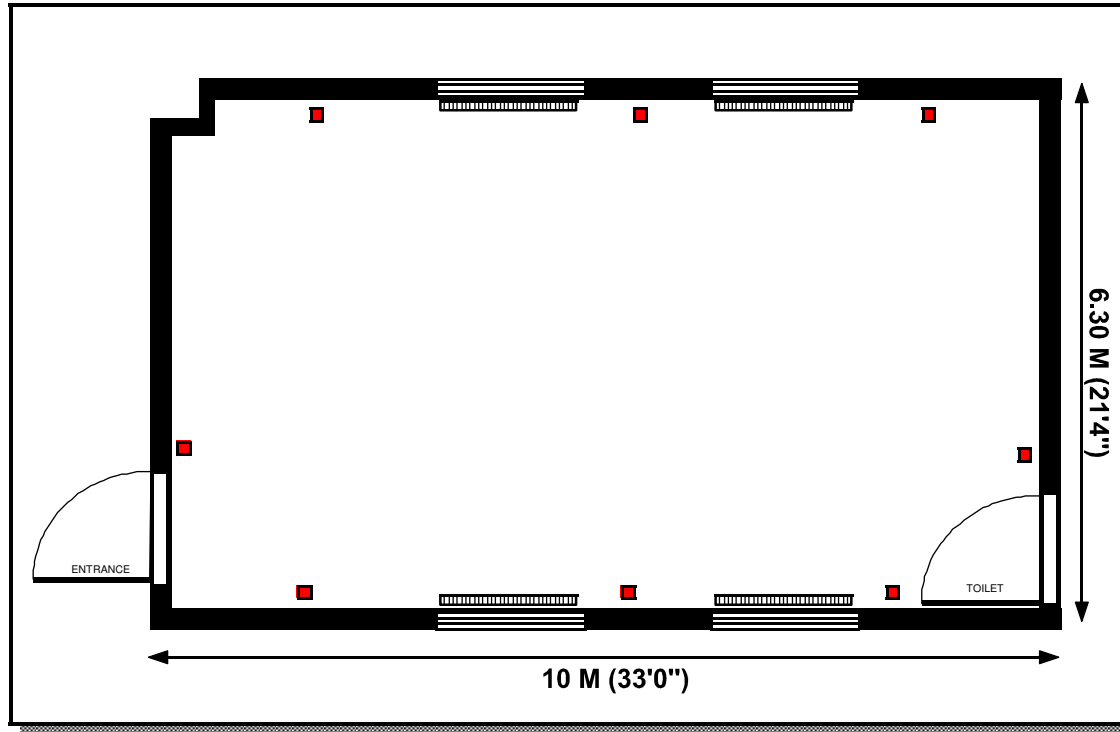

THEATRE STYLE	60
BOARDROOM STYLE	26
CLASSROOM STYLE	30
U SHAPE	24
RECEPTION	80

- *The largest of our three rooms. A comfortable and relaxing room, with plenty of natural light, attractive views and easy access to grounds.*

POWER POINTS 

